



SmartBright LED Downlight DN029B

DN029B G2 LED10/CCT PSR-E D120 NZ

SmartBright LED Downlight DN029B, 9 W, 1000 lumen, 3000 K, 4000 K, 6500 K, Frosted

SmartBright Downlight family is the perfect energy efficient LED replacement for conventional downlights. It offers three solutions around energy efficiency, selectable colour temperature and being a three step dimming downlight: Essential SmartBright Downlight G3 DN029B-1– trailing and leading edge dimmable downlight is the ideal functional replacement for conventional downlights. This affordable and easy to install fitting delivers high energy savings without compromising on light quality. This hassle-free Essential SmartBright DN029B-2 downlight provides you with the flexibility to select the perfect colour temperature (Warm White/Cool White/Day Light) for the application. Integrated with trailing/ leading edge dimming capability, this affordable and easy to install fitting delivers high energy savings without compromising on light quality. Essential SmartBright DN029B-3 step dimming

General Information

Lighting Technology	LED
Light source replaceable	No

Luminous Efficacy (rated) (Nom)	111.00 lm/W
Color rendering index (CRI)	80
Light source color	3000/4000/6500
Luminaire light beam spread	100°

Light Technical

Luminous Flux	1,000 lumen
---------------	-------------

Operating and Electrical

Input Voltage	220 to 240 V
---------------	--------------

perfect hassle-free replacement for conventional dimmable downlights. Adjust the light level straight from the switch and save cost with installation as a dimmer unit is not required.

Product data

Correlated Color Temperature (Nom) 3000 4000 6500 K

SmartBright LED Downlight DN029B

Dimensional drawing

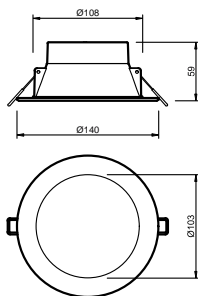

Line Frequency	or 60 Hz
Input Frequency	or 60 Hz
Power Consumption	W
Power Factor (Fraction)	0.8
Connection	Screw connection block

Temperature

Ambient temperature range	-20 to +40 °C
---------------------------	---------------

Controls and Dimming

Dimmable	Yes
----------	-----

Mechanical and Housing

Housing Material	Metal-Plastic
Reflector material	Polycarbonate
Optic material	Polycarbonate
Fixation material	Stainless steel
Housing Color	White
Optical cover/lens finish	Frosted
Overall length	mm
Overall width	mm
Overall height	mm
Overall diameter	mm

Datasheet, 2023, April 16

data subject to change

2

SmartBright LED Downlight

DN029B

Dimensions (Mechanical)	Ø108 x 114 mm	IK03	Driver failure rate at 5000 h	1.2 %
Protection class IEC	Safety class II		Median useful life L70B50	30,000 hour(s)

Approval and Application

Ingress protection code

Initial chromaticity (3000K@, 0.4400, 0.4030; 4000K@0.37600.3656; 6500K@0.31300.3370) 6

Power consumption tolerance +/-10%

Product Data

Full product code	871951425185400
Order product name	DN029B G2 LED10/CCT PSR-E D120 NZ
Order code	929002531519
Numerator - Quantity Per Pack	1
Numerator - Packs per outer box	12
Material number (12NC)	929002531519
Full product name	DN029B G2 LED10/CCT PSR-E D120 NZ
EAN/UPC - Case	8719514251861

Over Time Performance (IEC Compliant)

Photometric data

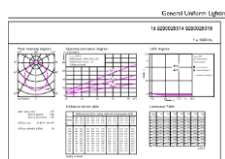

Lifetime

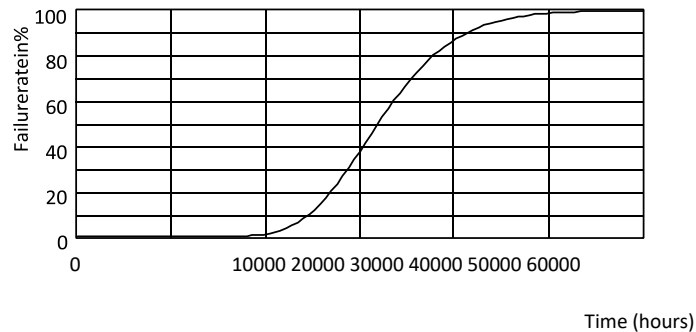
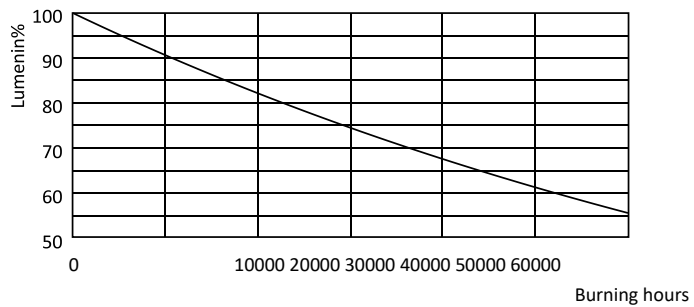

Lumen Maintenance Diagram - DN029B G2 LED10/CCT PSR-E D120 NZ

Life Expectancy Diagram - DN029B G2 LED10/CCT PSR-E D120 NZ



© 2023 Signify Holding All rights reserved. Signify does not give any representation or warranty as to the accuracy or completeness of the information included herein and shall not be liable for any action in reliance thereon. The information presented in this document is not intended as any commercial offer and does not form part of any quotation or contract, unless otherwise agreed by Signify. Philips and the Philips Shield Emblem are registered trademarks of Koninklijke Philips N.V.

www.lighting.philips.com 2023, April 16 - data subject to change

