

# PHILIPS

## Lighting



## RoadFlair Gen2

### BRP492 LED215/NW 150W 220-240V DM GM

RoadFlair Gen2, 21500 lm, 150 W, 740 neutral white, Analog, Safety class I

RoadFlair Gen2 is brand new design road lighting product family, set to meet customers' all-round requirements, including high lumen efficacy for energy saving and sustainability, aesthetic design for nice shape and appearance, quality material and components for product reliability and long lifetime, professional optics for various applications fulfillment, dimming and system control interface for improving municipal operations and offering future-proof features. RoadFlair Gen2 competitive price would help on the acceleration of road lighting LED transformation, to a more sustainable society and smarter city.

#### Product data

General Information		Power Consumption	150 W
Driver included	Yes	Power Factor (Fraction)	0.95
CE mark	CE mark	Connection	Screw connection block 3-pole
		Cable	-
Light Technical		Temperature	
Luminous Flux	21,500 lm	Ambient temperature range	-40 to +50 °C
Correlated Color Temperature (Nom)	4000 K		
Luminous Efficacy (rated) (Nom)	140 lm/W	Controls and Dimming	
Color rendering index (CRI)	>70	Dimmable	Yes
Light source color	740 neutral white	Control interface	Analog
Optical cover type	Polycarbonate micro lens optic		
Operating and Electrical		Mechanical and Housing	
Input Voltage	220 to 240 V	Housing Material	Aluminium pressure die cast
Line Frequency	50 or 60 Hz		

Datasheet, 2023, December 1

data subject to change

## RoadFlair Gen2

Housing Color	Aluminum and gray
Overall length	404 mm
Overall width	230 mm
Overall height	136 mm
Dimensions (Height x Width x Depth)	136 x 230 x 404 mm

### Approval and Application

Ingress protection code	IP66 [Dust penetration-protected, jet-proof]
Mech. impact protection code	IK08 [5 J vandal-protected]
Protection class IEC	Safety class I

### Initial Performance (IEC Compliant)

Luminous flux tolerance	+/-10%
Power consumption tolerance	+/-10%

### Product Data

Order product name	BRP492 LED215/NW 150W 220-240V DM GM
Full product name	BRP492 LED215/NW 150W 220-240V DM GM
Full product code	872016972833200
Order code	911401673406
Material Nr. (12NC)	911401673406
Numerator - Quantity Per Pack	1
EAN/UPC - Product/Case	8720169728332
Numerator - Packs per outer box	1
EAN/UPC - Case	8720169728332

### Dimensional drawing

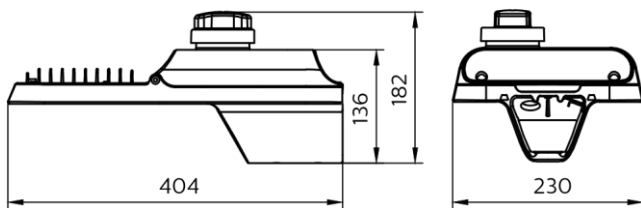

© 2023 Signify Holding All rights reserved. Signify does not give any representation or warranty as to the accuracy or completeness of the information included herein and shall not be liable for any action in reliance thereon. The information presented in this document is not intended as any commercial offer and does not form part of any quotation or contract, unless otherwise agreed by Signify, Philips and the Philips Shield Emblem are registered trademarks of Koninklijke Philips N.V.

www.lighting.philips.com 2023, December 1 - data subject to change